

Hydraulic accessories

Pressure switches type DG

Pressure switches close or open electrical contacts when under pressure. They are used to issue an electrical switching command or signal for further operations when a predefined pressure value is reached.

Different versions (with pressure setting on an adjusting knob, main and secondary switch, screw-on pressure switch) enable their use in a wide range of applications. A design-related difference (hysteresis) of 8... 20% is to be expected between the upper and lower switching point in piston-type pressure switches.

In contrast to this, the type DG5E and DG6 electronic pressure switches provide the option to select two independent pressure switching points and/or program or adjust the hysteresis.

Type DT is an analogous pressure sensor.

Features and benefits:

- Compact design
- Option of integration into the HAWE modular system
- Operating pressures up to 1000 bar

Intended applications:

- General hydraulic systems
- Machine tools



Nomenclature:	Spring loaded piston type pressure switch Electronic pressure switch Pressure transducer
Design:	Screw-in version Manifold mounting Designed for pipe fittings
P_{max}:	0... 1000 bar

Design and order coding example

DG 1 RF
DG 35 V -YS 8

Hydraulic connection

- With various tapped journals or to be mounted at fittings (type DG 3..)
- Combination with various fittings

Means of adjustment, mounting

- Manually adjustable (R) or Turn-knob (V, H = with lock) (type DG 3..)
- Design with bezel for installation in control panels (F)

Basic type Pressure switch type DG
 Type DG 1, 3, 8 (spring loaded piston type switch)
 Type DG 5, DG 6 (Electronic pressure switch with two switch points)
 Operating voltage 12 V DC, 24 V DC, 110 V AC, 230 V AC
 Analogous pressure transducer type DT
 Type DT 11
 Type DT 2

Function

DG 1 R

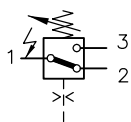

DG 8

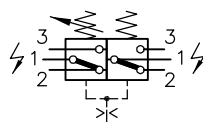

DG 3...

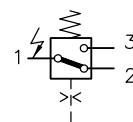

General parameters and dimensions

DG 1 R

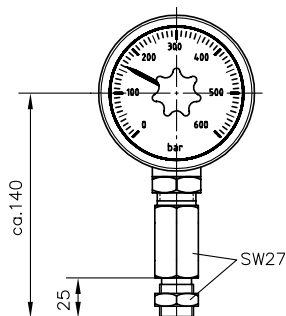

DG 8

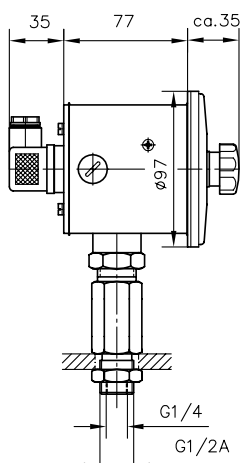

DG 3 ..

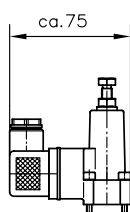

DG 6.

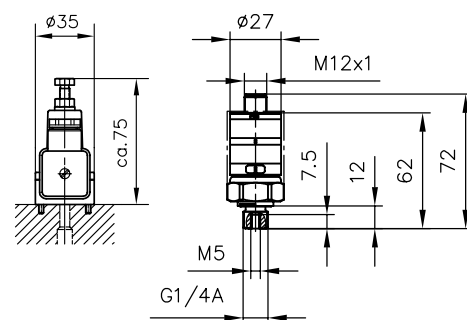

DG 5 E

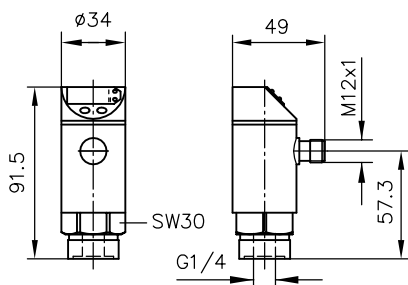

DT 11

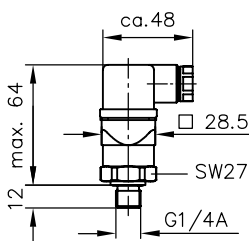

DT 2

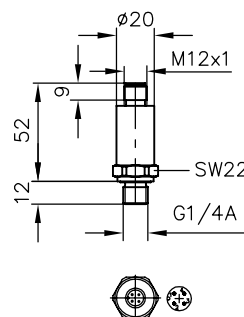

	Brief description	Adjustable pressure p_{max} [bar] ¹⁾	Ports (BSPP)	m [kg]
DG 1 R	Adjustment via turn-knob at the dial	20 ... 600	G 1/2 or G 1/4 A	1,3
DG 8	Version with two pressure switches Main switch: Adjustment via turn-knob at the dial Secondary switch: Adjustment via set screw	20 ... 600 and 20 ... 180	G 1/2 or G 1/4 A	1,35
DG 3..	Compact design for manifold mounting Adjustment via set screw	4 ... 700	G 1/4 or G 1/4 A ²⁾	0,3
DG 5 E	Electronic pressure switch with two switch points	0 ... 600	G 1/4 A	0,25
DG 6..		0 ... 400	G 1/4 A or M 5	0,08
DT 11	Analogous pressure sensor	0 ... 1000	G 1/4	0,08
DT 2		0 ... 600	G 1/4	0,7

1) The max. operation pressure of 700 bar is not influenced by the max. set pressure

2) For versions with adapter only

Associated technical data sheets:

- Pressure switches type DG: [D 5440](#)
- Electronic pressure switch type DG 5 E: [D 5440 E/1](#)
- Electronic pressure switch type DG 6: [D 5440 F](#)

Hydraulic accessories:

- Fittings type X, X 84: [D 7065](#), [D 7077](#)

Similar products:

- Analogous pressure sensor type DT 11: [D 5440 T/2](#)
- Analogous pressure sensor type DT 2: [D 5440 T/1](#)